

John Robinson was the father-in-law of Obediah Motley and Arthur Thompson. Obediah had married Elizabeth Robinson and Arthur had married Miriam Robinson.

The family land claims are superimposed here over a current era map. These land claims are a close approximate to the true shape of the claims.

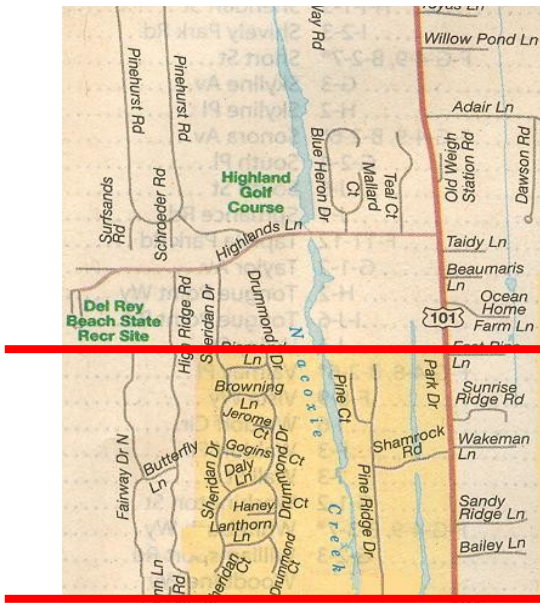

Obediah C. Motley
Land Claim

Miriam Thompson acquired John Robinson's land claim in 1850. It is assumed that Miriam purchased her father's land claim. Gearhart family recollections tell of Philip Gearhart purchasing the squatters rights for the claim from "Mrs. Marian Thompson, whose husband had gone to the mines in California in 1848 and had not returned". The recollections were correct except for the misspelling of Miriam. Philip Gearhart purchased the land claim in 1851. The Arthur H. Thompson land claim was abandoned by Miriam after Arthur was murdered in the California gold fields in April of 1849. Under provisional law a woman could not hold a land claim. This law was changed when the Oregon Territory was established.

John Robinson
Land Claim

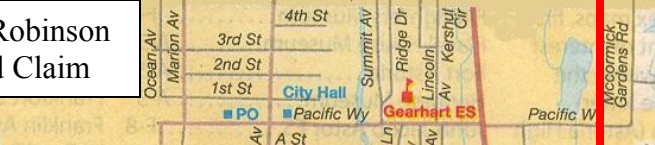
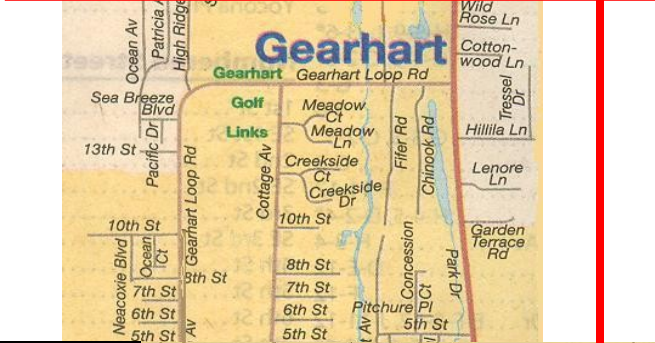

Arthur H. Thompson
Land Claim

Philip Gearhart also bought the Jefferson Lonk land claim in 1863. The Lonk farm is said to be adjacent to the "historic Thompson Claim" and extended to the sea. When the first surveyors came through the area they named the creek that ran through the historic Thompson farm, "Thompson Creek"

Philip Gearhart died in 1881 and John Gearhart, Philips son, sold 400 acres to Marshall Kinney in 1888. Kinney platted Gearhart Park on this land in honor of Philip Gearhart.

